

LASERMAX

92CD



New!

Folder 92CD

The LASERMAX Folder 92CD is designed to fanfold output from continuous form printers while bypassing the stacker unit of the printer. It can fold 6"–16" paper lengths up to 19.5" wide. The Folder 92CD features automated forms loading for easy start-up. It has a low profile to facilitate loading and viewing of paper movement through the folding mechanism. Its triple gear assembly allows form size changes simply by switching the format lever to an alternate position—no tools are required for this operation. A new version of the Folder 92CD is now available to fanfold pinless paper, eliminating excess waste caused by pinfed tractor holes. An optional kit replaces the gears and allows automatic form size changes. The delivery table may also be upgraded with a separate motor to efficiently transfer forms to the Vertical Stack Turner or PFT Cart.

Benefits of the LASERMAX Folder 92CD

- Automatic forms loading for easy start-up
- Triple gear assembly allows form length changes without tools
- Ergonomic design
- Low center point so paper movement can be seen through the folder mechanism
- Fully interlocked safety covers to protect operators from moving parts
- Plastic folding spirals for increased operator safety

Standard Features of the LASERMAX Folder 92CD

- Automated forms loading and loop control
- Microprocessor controlled
- LCD operator panel
- Adjustable slant folding table and belt speed to accommodate forms in a wide range of paper weights
- Onboard diagnostics

Optional Features of the LASERMAX Folder 92CD

- Kit for automatic form size changes
- Delivery table with separate motor
- New pinless version now available

Technical Specification

Folder 92CD

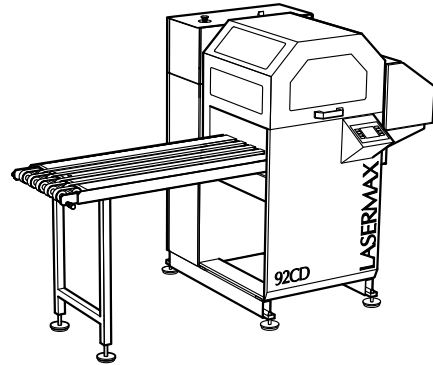

General

Print	Simplex or duplex
Paper feeding	Pinfed or pinless
Web width	6"-19.5" 155-495mm
Form length	6"-16"
Paper weight	55-200 gsm
Web speed	60-360 ft/min 0.30-1.80 m/s
Approvals	CE (98/37/EG), EMC, cUL, FCC
Color	Pearl-white

Electrical

North America	15A, 1 Phase, 208 V, REC=L6-15R
Other countries	10A, 200-240 (+6% -10%) VAC 1-50/60Hz
Power consumption	Standby 80 W Running 250 W
Heat emission	170 kcal/h, 720 kJ/h, 680 BTU

Environment

Operating noise	65 dB(A)
Relative humidity	50 ±10%

Physical

Length	45.3"	1150mm
with table	88.6"	2250mm
Width	49"	1240mm
Height	59"	1500mm
Weight with table	1235 lbs	560 kg

Service Area

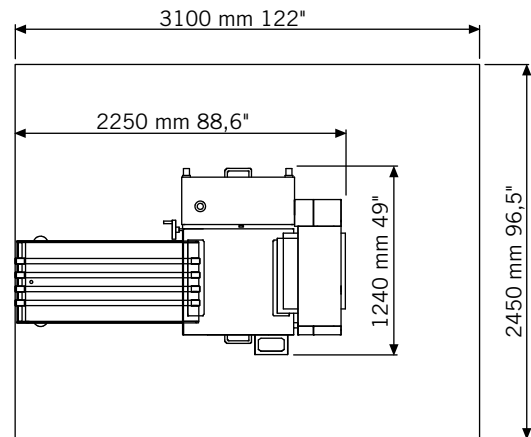

Options

- Interface to all printers
- Infeeder to all printers
- Vertical Stack Turner 192CD
- Kit for automatic form size changes
- Delivery Table with separate motor
- Printed Forms Transport (PFT) Cart
- Pinless infeed

Lasermax Roll Systems reserves the right to make any technical amendments without prior notification.